

Verification Request for the Leveling Mount Height of the Machine which the Customers Relocated Themselves

Applicable models

DFL7360FH, DFL7361, DFL7362

Report of typographical error

There was an error relating to the "leveling mount height upper limit" indicated in the installation manual.

If a leveling mount is raised to the wrong upper limit as indicated in the installation manual, there is a risk that it could drop and that feet and hands could be caught or amputated by the machine.

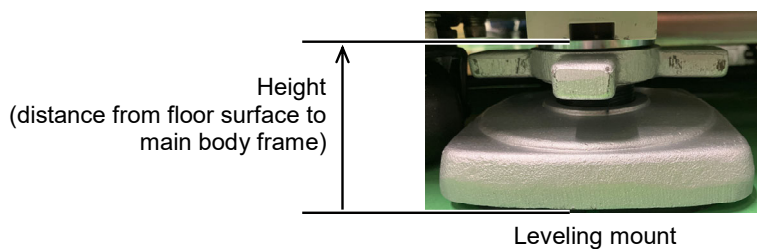

Verification request

If machine installation and relocation operations were not performed by a DISCO customer engineer (e.g., if you relocated the machine yourself, referring to the manual), please verify that the leveling mount height is equal to or less than the "Correct upper limit" indicated on the following pages.

If there is a leveling mount whose height exceeds the upper limit, stop machine operation and contact a DISCO customer engineer.

In addition, if you are concerned about performing the verification operation yourself, please notify a DISCO customer engineer.

We apologize sincerely for causing you trouble and inconvenience.
We are extremely grateful for your understanding and cooperation.

Inquiries

Please contact your local DISCO sales representative or customer engineer if you have any questions regarding this matter.

Leveling Mount Height Verification

For safety purposes



Do not place your feet and hands under the machine during the operation

If the machine should topple down, you may be caught under the machine, or if the leveling mount should come off, your feet and hands could be caught or amputated by the machine.

Wear safety shoes and protective gloves during the operation

Otherwise, your feet and hands could be caught or amputated by the machine.

DFL7360FH

Wrong upper limit (typographical error in manual)	Correct upper limit
95 mm	68 mm

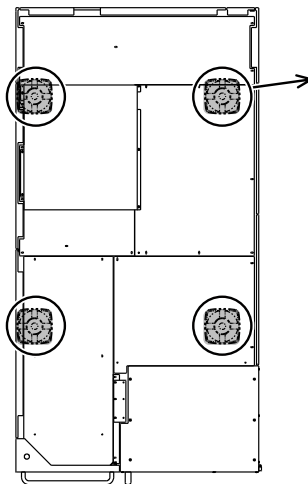

Top side

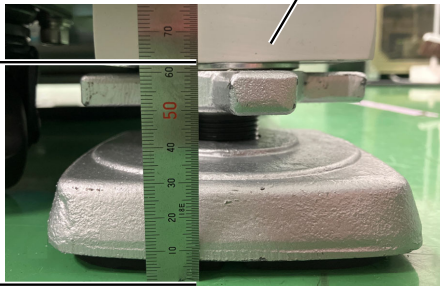

68 mm or less

Main body frame

○ : Verify that the leveling mount height (distance from the floor surface to the main body frame) is 68 mm or less using a ruler or the like (4 locations).

- If spacers for adjusting the height are used under the leveling mount, verify the distance from the top surfaces of the spacers to the main body frame.

DFL7361

Wrong upper limit (typographical error in manual)	Correct upper limit
95 mm	Transport section: 68 mm Processing section: 82 mm

[Transport section]

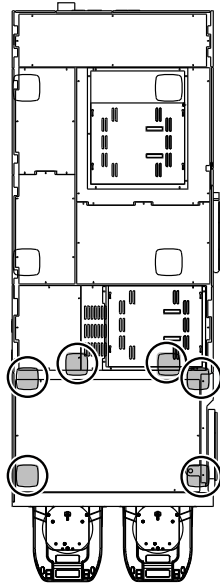

Top side

Main body frame

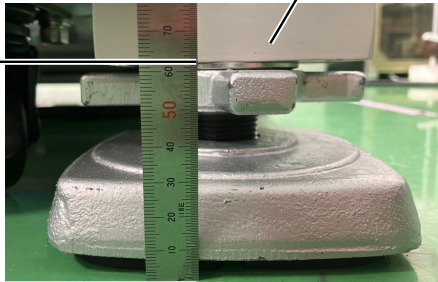

68 mm or less

○: Verify that the leveling mount height (distance from the floor surface to the main body frame) is 68 mm or less using a ruler or the like (6 locations).

- If spacers for adjusting the height are used under the leveling mount, verify the distance from the top surfaces of the spacers to the main body frame.

[Processing section]

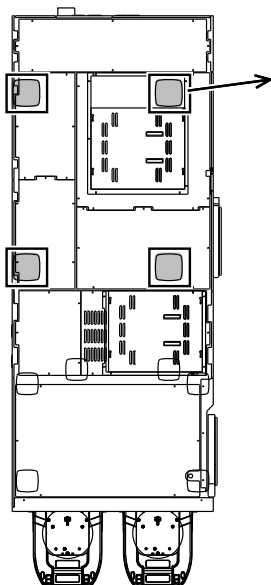

Top side

Main body frame

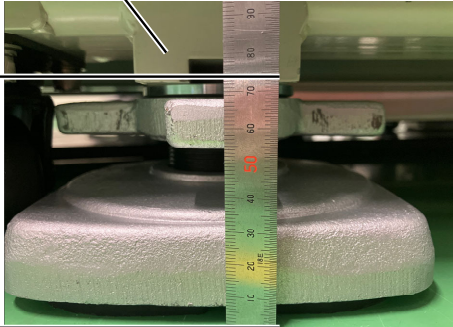

82 mm or less

□: Verify that the leveling mount height (distance from the floor surface to the main body frame) is 82 mm or less using a ruler or the like (4 locations).

- If spacers for adjusting the height are used under the leveling mount, verify the distance from the top surfaces of the spacers to the main body frame.

DFL7362

Wrong upper limit (typographical error in manual)	Correct upper limit
95 mm	Transport section: 64 mm Processing section: 77 mm



Do not verify the leveling mount on the front right side of the processing section (dotted circle in image below)

Since you will place your hand under the machine, there is a risk that it could be caught or amputated by the machine if the leveling mount drops.

[Transport section]

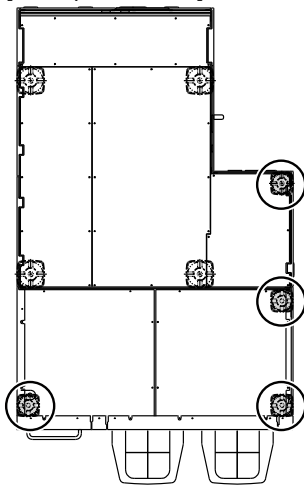

Top side

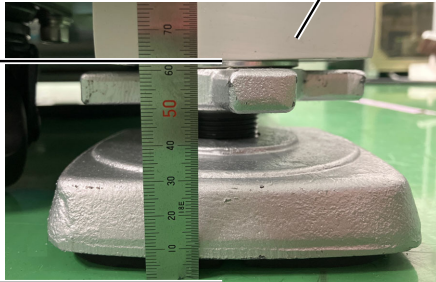

64 mm or less

Main body frame

○: Verify that the leveling mount height (distance from the floor surface to the main body frame) is 64 mm or less using a ruler or the like (4 locations).

- If spacers for adjusting the height are used under the leveling mount, verify the distance from the top surfaces of the spacers to the main body frame.

[Processing section]

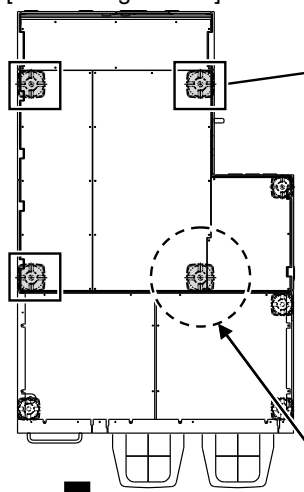

Top side

Front side

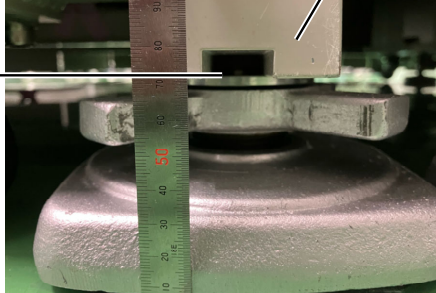

77 mm or less

Main body frame

□: Verify that the leveling mount height (distance from the floor surface to the main body frame) is 77 mm or less using a ruler or the like (3 locations).

- If spacers for adjusting the height are used under the leveling mount, verify the distance from the top surfaces of the spacers to the main body frame.

Do not verify this leveling mount.